

SYSTEM

RFS600 Series RF Admittance/Capacitance Level Switch

DIGITAL TECHNOLOGY FOR OPTIMIZED MEASUREMENT

High and low Point level control for liquids, slurries, inter face and granular stored in tanks, bins, silos or other containers. It also could be used as a plug condition detector in free-flowing granular solids. Using special probe and circuit to ignore material build-up on probe, RFS-600 is design for easy on-site installation and no moving parts for long term reliability in harsh environment. It can be powered by either 24VDC or 110/220VAC. Remote models are available for high temperature or high vibration applications.



FEATURES & BENEFITS

- ☐ Wide application field for liquid, slurry, granular and interface
- ☐ Individual probe and circuit to ignore material build-up
- ☐ Single point calibration button, conductivity material don't need calibration
- ☐ Easy-installation
- ☐ NEMA 4 explosion-proof enclosure
- ☐ Sensor could be lengthen or shorten according to the field application
- ☐ DPDT output
- ☐ Maintenance-free
- ☐ Economical

PRIMARY AREAS OF APPLICATION

- ☐ Aluminum Smelters
- ☐ Asphalt Plants
- ☐ Automotive Plants
- ☐ Brewery
- ☐ Cement Plants
- ☐ Confectionary Plants
- ☐ Chemical Plants
- ☐ Coal Plants
- ☐ Coke Plants
- ☐ Fertilizer Plants
- ☐ Food Plants
- ☐ Flour Plants
- ☐ Glass Plants
- ☐ Paint Plants
- ☐ Paper Plants
- ☐ Pharmaceutical Plants
- ☐ Plastic Plants
- ☐ Power Stations
- ☐ Sewage Treatment Plants
- ☐ Soft Drink Plants
- ☐ Steel Mills
- ☐ Water Treatment Plants

SPECIFICATION

Power	120 ± 25 VAC, 50/60 Hz (std.) 230 ± 25 VAC, 50/60 Hz (optional) 15-30 Vdc (optional) (5 watts max.)	Differential	Worst case with horizontal sensing element, 1/64" (.4mm) or less
Output	DPDT Relay	Stability	0.01 pF/6 mo. Max.
Contact Rating	120 VAC 5A Non-inductive, 3A Inductive 240 VAC 5A Non-inductive, 2A Inductive 24 Vdc 5A Non-inductive, 1A for Inductance up to 300 mH	Recommended Operating Temp.	40°F to 145°F (-40°C to 63°C)
Spark Tolerance	100 A (std)	Temperature Effect	± 0.01 pF/40°F(4°C)
Fail Safe	High (HLFS) or Low (LLFS) field adjustable	Line Voltage Effect	± 0.002 pF/20 V
Response Time	Approx. 0.2 sec. Adjustable 0-90 seconds (optional)	Sensing Element Connection	See chart. Threaded flange mounting (optional)
Sensitivity	0.1 pF	Electronic Housing	NEMA 4 explosion-proof enclosure for Class 1 Div. 1 and 2, Groups A,B,C,D, Class II Div. 1 and 2, Groups E, F, G

Sensor	Process Pressure & Temperature	Std. mtg.	O.D. & Wet Material	Max. I.L.	Application
P01	200 psi @ 410°F 14 BAR @ 210°C	3/4" NPT	3/8" O.D. 316 SS & PPO	6 ft	Common service liquids, light slurries, and granular
P02	200 psi @ 450°F 14 BAR @ 232°C	1" NPT	1/2" O.D. 316 SS & TFE	10 ft	Heavy duty liquid, slurry or granular
P03	50 psi @ 300°F 3 BAR @ 149°C	3/4" NPT	3/8" O.D. 316ss & PFA (bonded)	6 ft	Corrosive liquids (water-like viscosity, high level/vertical mount)
P04	1 psi @ 180°F 0 BAR @ 82°C	3/4" NPT	1/4" O.D. 316 SS & TFE	50 ft	Flexible cables S.E.
P05	500 psi @ 300°F 34.5BAR @ 149°C	3/4" NPT	0.093" O.D. 316ss & PFA (bonded)	50 ft	Flexible cables S.E. for corrosive liquid
P06	0 psi @ 1500°F 0 BAR @ 816°C	1-1/2" NPT	1/2" O.D. SS & ceramic	4 ft	High temperatures
P07	200 psi @ 500°F 14 BAR @ 260°C	3/4" NPT	1/2" O.D. 316 SS & PEEK	6 ft	High temperatures service liquids, light slurries, and granular
P08	300 psi @ 300°F 21 BAR @ 149°C	1 1/2" Tri-clamp	3/8" O.D. 316 SS & TFE	6ft	Sanitary Service

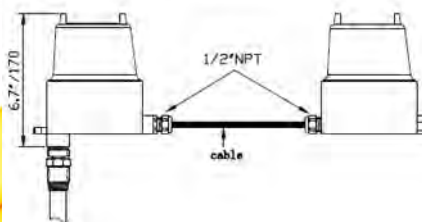
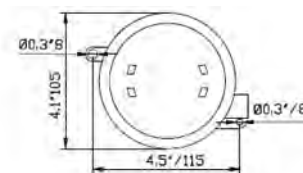
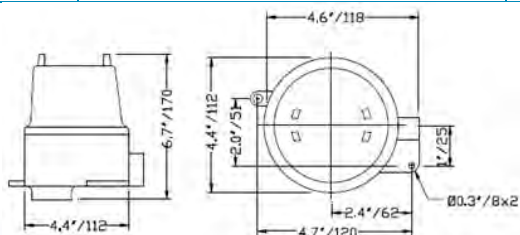

DELTA-PHASE ELECTRONICS, INC.
3 Peters Canyon Rd, Suite 100.,
Irvine, CA 92606 U.S.A.
Phone: (949) 701-7728
<http://www.delta-phase.us>